

PetFree™

Create PetFree Areas Indoors and Out

by **Invisible Fence** Brand

PetFree™ Outdoor Plus Owner's Manual

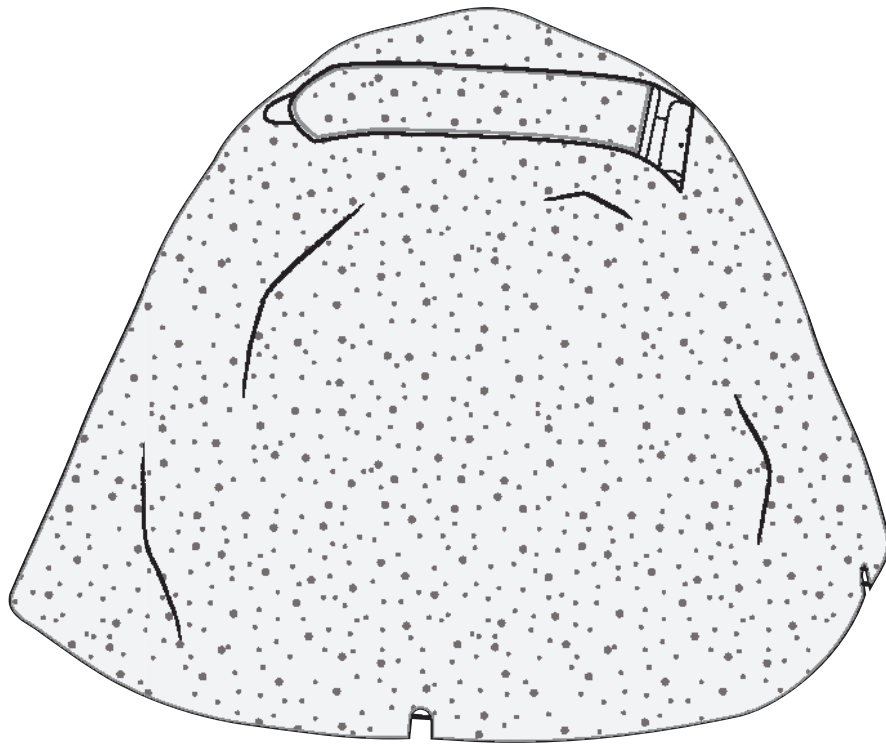

www.invisiblefence.com

Important Precautions

- Invisible Fence® Brand pet containment systems have contained over two million pets. However, there are some precautions you should take.
- Read and retain manuals: Read the entire Owner's Manual before using your new Invisible Fence Brand pet containment system.
- Adhere to all warnings and cautions contained in any Invisible Fence Brand manual.

⚠ WARNING

WARNING indicates a hazardous situation, which, if not avoided, could result in death or serious injury.

CAUTION

CAUTION used without the safety alert symbol, indicates a hazardous situation, which, if not avoided, could result in harm to your pet.

NOTICE

NOTICE is used to address safe use practices not related to personal injury.

⚠ WARNING

- Not every pet can be trained to avoid the established boundary. Sometimes even a properly trained pet may cross the boundary. Therefore, Invisible Fence, Inc., as well as Invisible Fence Distributors and Dealers cannot guarantee the system will, in all cases, keep a customer's pet within the established boundary. Accordingly, if a customer has reason to believe that their pet may pose a danger to others, or harm itself, the customer should not rely solely upon the Invisible Fence Brand pet containment system to keep the pet from crossing the boundary.
- Do not install, connect, or remove your system during a lightning storm. If the storm is close enough for you to hear thunder, it is close enough to create hazardous surges.

CAUTION

- Read and follow the important tips on how to avoid pressure necrosis in your Invisible Fence Brand Computer Collar® manual.
- Train your pet according to the instructions in the Invisible Fence Brand training manuals. Complete all steps before allowing your pet to run free. Do not become overly confident if your pet has become conditioned to the Invisible Fence Brand pet containment system sooner than expected.
- Your Invisible Fence Brand Dealer has professionally installed your pet containment system and ensured it is working properly. You will want to perform periodic maintenance checks to make sure the system is properly functioning for your pet's safe containment.
- Check the Invisible Fence Brand transmitter periodically to make sure it is operating properly. To do this, simply bring the Computer Collar to the edge of the signal field to verify function.
- Do not attempt to service any Invisible Fence Brand equipment. Refer all service to your authorized Invisible Fence Brand Dealer. Only your authorized Invisible Fence Brand Dealer should make adjustments to your pet containment system.
- All Invisible Fence Brand pet containment systems are designed for domesticated animal use only. Never attempt to use this product for any purpose not specifically described in this manual.

NOTICE

- If using the Boundary Wire option, use care when mowing, aerating, or trimming your lawn so as not to cut the loop wire.
- If you have any questions about any aspect of your Invisible Fence Brand pet containment system, call your Invisible Fence Brand Dealer immediately.

Congratulations on your purchase of the PetFree™ Outdoor Plus Solution. Please read and review this entire manual to become familiar with PetFree Outdoor Plus components and its operation. It is strongly recommended you review this information before using the product.

PetFree Outdoor Plus gives you control over the areas a pet or pets have access to outside your home. It is designed to work independently, or to complement your Invisible Fence® Brand 800 Series electronic pet containment system. **It is not designed to operate as a containment transmitter.**

Table of Contents

Components	4
How the Systems Works	4
Operating Guide - Wireless	5
Operating Guide - Wired	6
Operating Guide - Multi-Pet Homes	7
Operating Guide - Rate Feature	7
Troubleshooting.....	8
Battery Disposal.....	8
Perchlorate Battery	8
Important Recycling Advice.....	8
Compliance	9

Components

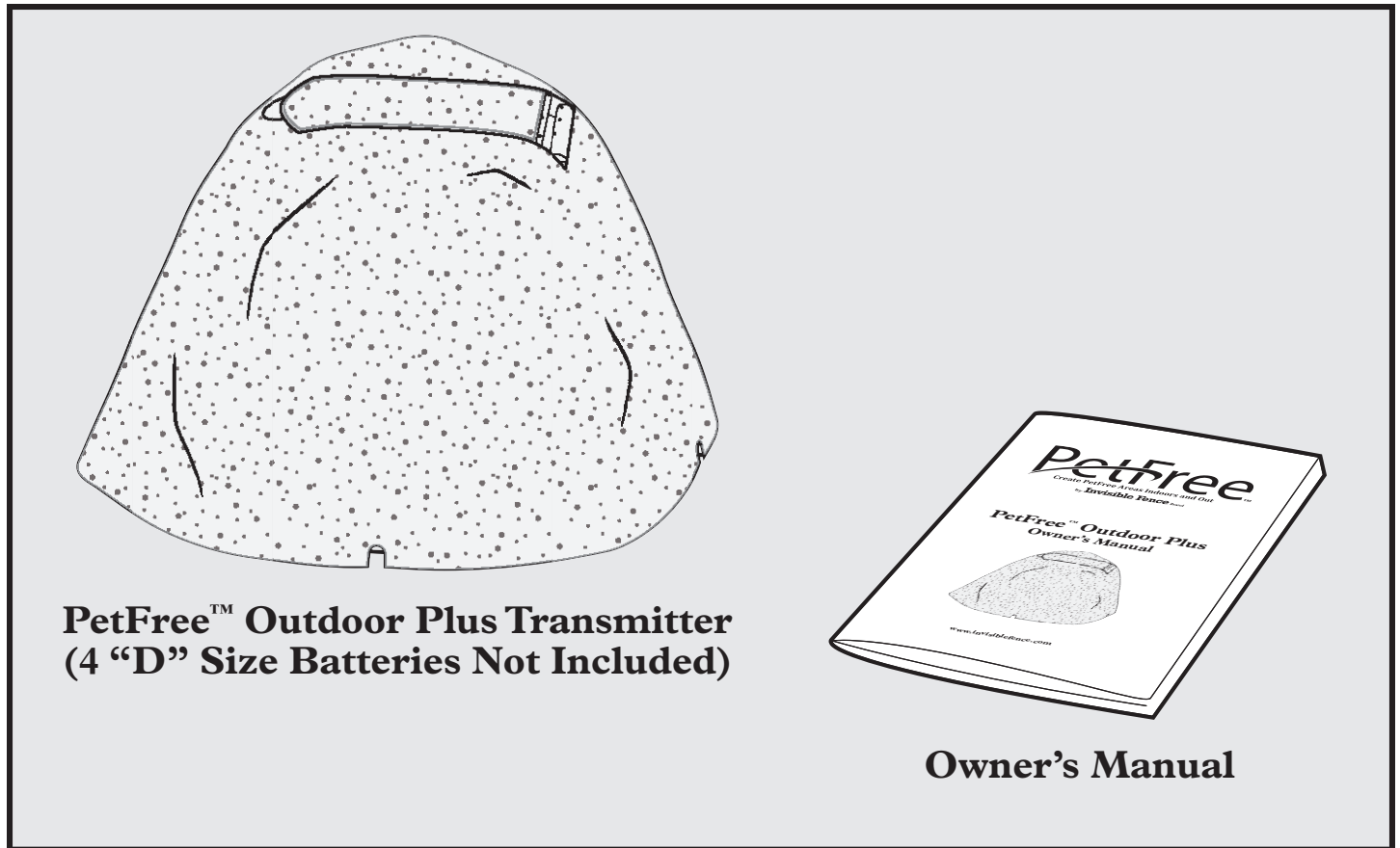

How the System Works

The PetFree™ Outdoor Plus Transmitter, disguised as a rock, produces a spherical signal field up to 10 feet in diameter. Your pet's Computer Collar® detects this signal field and delivers a mild correction to deter your pet from entering the area.

You also have the option to create a custom shaped signal field loop using up to 100 feet of boundary wire.

The transmitter is powered by 4 "D" size alkaline batteries (not included). Typical battery life ranges from 6 to 12 months, depending on the set up and operation of the PetFree Outdoor Plus transmitter. You may experience battery life less than or greater than this range. See Operating Guide: Rate Feature on page 7 to understand how set up may affect battery life. Check the LCD display every month to see if the Low Battery indicator is displayed.

The transmitter is weatherproof but cannot be submersed in water.

Definition: A correction is a training term used to describe an action taken to discourage unwanted pet behavior. The Computer Collar, worn by your pet, applies a correction when your pet enters a shielded area or crosses the boundary of an Invisible Fence® Brand electronic pet containment system. Corrections are used in combination with training and rewards to alter unwanted pet behavior.

Operating Guide: Wireless

Important: To ensure your pet does not receive an unintended correction, make sure your pet is not wearing the Computer Collar® when turning ON or adjusting the PetFree™ Outdoor Plus transmitter.

1. Power up the PetFree Outdoor Plus transmitter

- Locate the battery door on the bottom of the PetFree Outdoor Plus transmitter. Remove the battery door by loosening the 4 Phillips head screws. Note: the screws are retained in the battery door lid.
- Place 4 “D” size alkaline batteries into the unit as illustrated inside the compartment.
- Ensure the o-ring is completely set in the slot and free of dirt.
- Replace the battery lid and tighten all 4 screws snug. A loose lid may allow moisture to enter the unit resulting in product failure.
- Turn the PetFree Outdoor Plus transmitter upright and open the lid exposing the LCD display and range buttons.
- Press the up (+) button once to turn ON the PetFree Outdoor Plus transmitter.

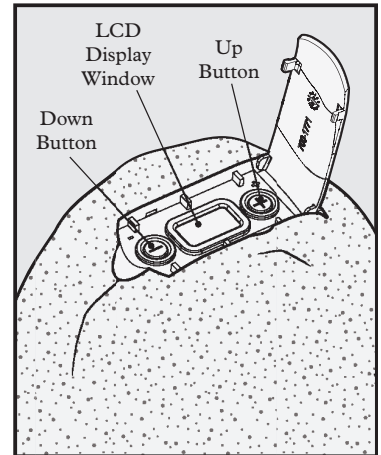

2. Adjust signal field range

- Determine the desired location and the signal field range required. The range can be set from a minimum radius of 10 inches (25 cm) up to a maximum radius of 5 feet (1.5 m).
- With the transmitter ON, press the RANGE UP (+) or the RANGE DOWN (-) buttons to increase or decrease the signal field range. Each segment of displayed bar represents an approximate 10-inch radius of range from the center of the transmitter.
- Once the range is set, place the PetFree Outdoor Plus transmitter in the desired area.

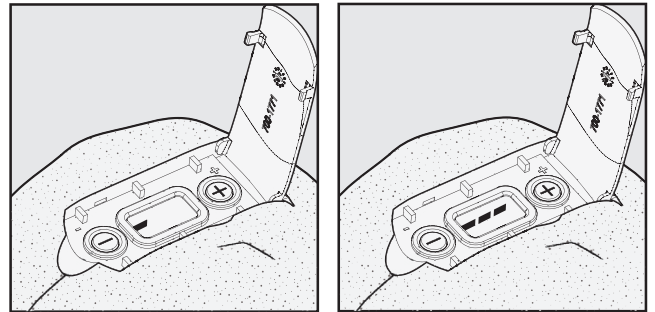

3. Verify the signal field range

- Make sure the PetFree Outdoor Plus transmitter is ON.
- Holding the Computer Collar at the appropriate height for placement on your pet's neck, start outside the range and walk slowly towards the PetFree Outdoor Plus transmitter. **Do not touch the correction posts at this time.**
- The Computer Collar will beep as it approaches the outer range of the signal field width set in Step 2. The beeping will be followed by a correction.
- If the Computer Collar fails to beep, see the troubleshooting chart found on page 8.
- Adjust range and/or relocate the PetFree Outdoor Plus transmitter until desired area is protected.

4. Checking for low battery

- Open the lid exposing the LCD display and buttons.
- If the LCD display is flashing, it is time to replace the batteries.
- After replacing the batteries you will need to check and see if the range for the signal field is set to the desired area.

Operating Guide: Wired

You can create a signal field using up to 100 feet of boundary wire. Use a wire that is rated for direct burial. The recommended direct burial wire can be purchased from your local Invisible Fence® Brand professional. Visit www.invisiblefence.com to find an authorized dealer in your area.

Important: To ensure your pet does not receive an unintended correction, make sure your pet is not wearing the Computer Collar® when turning ON or adjusting the PetFree™ Outdoor Plus transmitter.

1. Preparation

Warning: Before installing the boundary wire, make sure that there are no buried power, telephone or other electrical cables in the area. Many underground cables carry high voltage and digging into them may lead to hazard from shock or electrocution. Have your local utility company mark your underground lines. Dial 811 from anywhere in the country and your call will be routed to your local One Call Center. For more information on “Know What’s Below” visit www.call811.com.

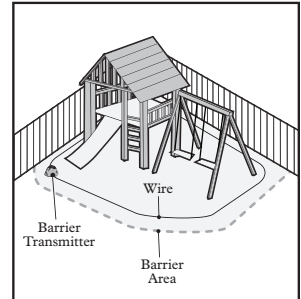

- When using the wire option it will be required to start at a minimum range setting of 2 segments. A setting below 2 segments will not produce a signal field great enough to be picked up by the Computer Collar.
- The range will vary depending on the length of wire and shape of the layout.
- The wire must make a complete loop starting and ending at the PetFree Outdoor Plus transmitter.
- It is important to test the system and make adjustments to your layout prior to burying the boundary wire.

2. Connect the Wires to the PetFree Outdoor Plus

- Locate the battery door on the bottom of the PetFree Outdoor Plus transmitter. Remove the battery door by loosening the 4 Phillips head screws. Note: the screws are retained in the battery door lid.
- Locate the switch inside the battery compartment labeled “INTERNAL/EXTERNAL”. This switch allows the PetFree Outdoor Plus to operate as a wireless (INTERNAL) or wired (EXTERNAL) unit. Move the switch to the EXTERNAL position.
- Strip ½ inch of insulation from each end of the boundary wire. Bend the ends to form a 90 degree angle.
- Loosen the 2 Phillips head wire connection screws adjacent to the battery compartment and insert the boundary wire as shown. Once in place, tighten each screw. Make sure the bare wires do not touch each other.
- Place the 4 “D” size alkaline batteries into the unit as illustrated inside the compartment.
- Ensure the o-ring is completely in the slot and free of dirt. Replace the battery lid and tighten all 4 screws snug. Ensure wires do not interfere with the fit of the battery compartment lid. A poorly fitted lid may cause moisture to enter the unit resulting in product failure.
- Position the PetFree Outdoor Plus unit in the desired location.

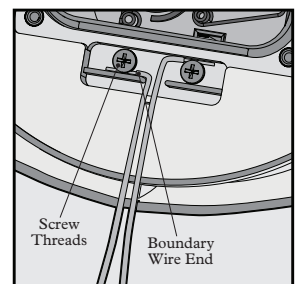
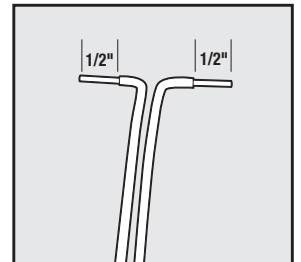
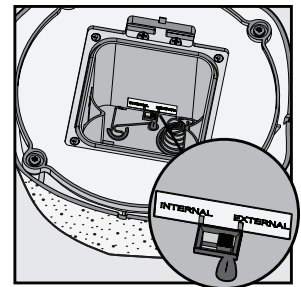

3. Test the Signal Field

- Start with the range set to 2 segments and adjust the range up to 6 segments to get your desired coverage. Press and release the RANGE UP (+) button 2 times to start.
- Holding the Computer Collar® at the approximate height of your pet’s neck, start outside the signal field and walk slowly towards the boundary wire. Do not touch the correction posts at this time.
- The Computer Collar will beep as it approaches the outer range of the signal field width. The beeping will be followed by a correction.
- If the Computer Collar fails to beep, see the troubleshooting chart found on page 8.
- Adjust the signal field range and boundary wire position until the desired area is covered.

4. Install the Boundary Wire

- The boundary wire may be buried 1 to 3 inches deep or held in place with landscape staples. Landscape staples are recommended only if the installation area is not one that will require frequent lawn care.
- Landscape staples can be purchased from your local Invisible Fence® Brand professional. Visit www.invisiblefence.com to find an authorized dealer in your area.

Operating Guide: Multi-Pet

Your PetFree™ Outdoor Plus solution and Computer Collars® allows you to set “Different Rules for Different Pets”. All PetFree Outdoor Plus transmitters and Computer Collars are preset to operate on Channel A. In most homes this setting is usually sufficient as long as all pets are required to avoid the same PetFree areas. In some multi-pet homes it may be desired to allow one pet access to an area while denying access to another.

When set to Channel A, PetFree Outdoor Plus denies access to pets wearing a Computer Collar programmed to Channel A. When set to Channel B, PetFree Outdoor Plus denies access to pets wearing a Computer Collar programmed to Channel B. When set to Channels A & B, PetFree Outdoor Plus denies access to all pets wearing a Computer Collar.

Changing the Channel Setting on the PetFree Outdoor Plus Transmitter

- Remove the battery door by loosening the 4 Phillips head screws.
- Remove the 4 “D” size alkaline batteries if you had already placed them inside the unit.
- Locate the 4 position dip switch inside the battery compartment. The first 2 positions of this switch allow the PetFree Outdoor Plus to produce one of 3 signal types.
- The label inside the battery compartment illustrates the positions required to select Channel A, Channel B or Channels A & B.
- Place the 4 “D” size alkaline batteries into the unit as illustrated inside the compartment.
- Ensure the o-ring is completely in the slot and free of dirt. Replace the battery lid and tighten all 4 screws snug. Ensure wires, if installed, do not interfere with the fit of the battery compartment lid. A poorly fitted lid may cause moisture to enter the unit resulting in product failure.

Chnl	1	2	Rate	3	4
A	↓	↓	Slow	↓	↓
B	↓	↑	↑	↓	↑
A&B	↑	↑	↓	↑	↓
US Patents: 7046152, 7068174, 7117822 Patents Pending			Fast	↑	↑

Contact your local Invisible Fence Brand professional about options available for changing the Channel setting in your Computer Collars. Visit www.invisiblefence.com to find an authorized dealer in your area.

Operating Guide: Rate Feature

Your PetFree Outdoor Plus solution also allows you to select 1 of 4 signal field transmission rates. This feature is designed to extend battery life and to allow overlapping signal fields. However, the transmission rate has a direct affect on the reaction time of the Computer Collar.

All PetFree Outdoor Plus transmitters are preset to the Slow Rate setting. This setting provides the slowest Computer Collar reaction time while conserving the most energy. For most situations this setting is sufficient. Expected battery life should be 6+ months at this setting.

Setting the Rate to Fast provides the fastest Computer Collar reaction time while consuming the most energy. This selection is the best choice when training a pet to a new PetFree area since it provides the sharpest boundary edge. Expected battery life should be 3+ months at this setting.

Changing the Rate Setting on the PetFree Outdoor Plus Transmitter

- Remove the battery door by loosening the 4 Phillips head screws.
- Remove the 4 “D” size alkaline batteries if you had already placed them inside the unit.
- Locate the 4 position dip switch inside the battery compartment. The last 2 positions of this switch control the Rate setting.
- The label inside the battery compartment illustrates the positions required to select the Slow through Fast settings.
- Place the 4 “D” size alkaline batteries into the unit as illustrated inside the compartment.
- Ensure the o-ring is completely in the slot and free of dirt. Replace the battery lid and tighten all 4 screws snug.

Chnl	1	2	Rate	3	4
A	↓	↓	Slow	↓	↓
B	↓	↑	↑	↓	↑
A&B	↑	↑	↓	↑	↓
US Patents: 7046152, 7068174, 7117822 Patents Pending			Fast	↑	↑

Troubleshooting

No segments appear on the LCD	<ul style="list-style-type: none"> • Press the RANGE UP (+) button. • Check/replace the batteries in the PetFree™ Outdoor Plus transmitter – See Step 4 on page 5 (Checking for low battery).
PetFree Outdoor Plus does not appear to work	<ul style="list-style-type: none"> • Check/replace the Power Cap® in the Computer Collar® - Refer to your Computer Collar owner's manual. • Check/replace the batteries in the PetFree Outdoor Plus transmitter – See Step 4 on page 5 (Checking for low battery). • Increase signal field range – See Step 2 on page 5 (Adjust signal field range). • Ensure the INTERNAL/EXTERNAL switch is in the correct position. Select INTERNAL when operating wireless and EXTERNAL when operating a wired loop. • If using the wired option, check to ensure the wire is connected to the transmitter, the bare wires are not touching each other at the terminal and there are no breaks in the wire – See Step 2 on page 6.
Range is too low or too high	<ul style="list-style-type: none"> • Adjust the PetFree Outdoor Plus transmitter to increase or decrease the signal field range – See Step 2 on page 5 (Adjust signal field range). • Metal object may distort the shape of the signal field. Consider an alternate location for the PetFree Outdoor Plus transmitter.
Pet seems to receive no correction	<ul style="list-style-type: none"> • Check/replace the Power Cap in the Computer Collar - Refer to your Computer Collar owner's manual. • Adjust the PetFree Outdoor Plus transmitter to increase or decrease the signal field range – See Step 2 on page 5 (Adjust signal field range). • Check the fit of the Computer Collar on your pet's neck – Refer to your Computer Collar owner's manual.

If your problem cannot be solved by the Troubleshooting Guide above, call your Invisible Fence® Brand Dealer.

Battery Disposal

Separate collection of spent batteries is required in many regions; check the regulations in your area before discarding spent batteries. The Computer Collar operates on one (1) Lithium (Li-MnO₂) battery with a 3 Volt, 160 mAh capacity, replace only with equivalent battery that may be obtained from your Invisible Fence Dealer. The Transmitter operates on 4 Alkaline-Manganese Dioxide (Zn/MnO₂) batteries with a 1.5 Volt, 12,000mAh capacity.

Perchlorate Battery

Perchlorate Material – special handling may apply. See www.dtsc.ca.gov/hazardouswaste/perchlorate.

Important Recycling Advice

Please respect the Waste Electrical and Electronic Equipment regulations in your country. This equipment must be recycled. If you no longer require this equipment, do not place it in the normal municipal waste system. Please return it to where it was purchased in order that it can be placed in our recycling system. If this is not possible, please contact your Invisible Fence Brand Dealer.

Compliance

US and Canada

FCC ID: KE3-3001054

IC: 2721A-3001054

This device complies with Industry Canada rules. This device complies with part 15 of the FCC Rules. Operation is subject to the following two conditions: (1) This device may not cause harmful interference, and (2) this device must accept any interference received, including interference that may cause undesired operation.

⚠ CAUTION Modification or changes to this equipment not expressly approved by Radio Systems® Corporation may void the user's authority to operate the equipment.

NOTE: This equipment has been tested and found to comply with the limits for a Class B digital device, pursuant to part 15 of the FCC Rules. These limits are designed to provide reasonable protection against harmful interference in a residential installation. This equipment generates, uses, and can radiate radio frequency energy and, if not installed and used in accordance with the instructions, may cause harmful interference to radio communications. However, there is no guarantee that interference will not occur in a specific installation. If interference does occur to radio or television reception, which can be determined by turning the equipment off and on, the user is encouraged to try to correct the interference by one or more of the following measures:

- Reorient or relocate the receiving antenna.
- Increase the separation between the equipment and the receiver.
- Connect the equipment to an outlet on a circuit different from that to which the receiver is connected.
- Consult the dealer, or an experienced radio/TV technician for help.

This Class B digital apparatus complies with Canadian ICES-003.

Cet appareil numérique de la classe B est conforme à la norme NMB-003 du Canada.

Australia

This device complies with the applicable EMC requirements specified by the ACMA (Australian Communications and Media Authority).

European Union



This equipment has been tested and found to comply with relevant EU Electromagnetic Compatibility, Low Voltage and R&TTE Directives. Before using this equipment outside the EU countries, check with the relevant local R&TTE authority. Unauthorized changes or modifications to the equipment that are not approved by Radio Systems Corporation are in violation of EU R&TTE regulations, could void the user's authority to operate the equipment, and void the warranty.

This product is in full compliance with the provisions of the R&TTE - Directive 1999/05/EEC. The Declaration of Conformity can be found at: <http://www.invisiblefence.com/international/declarations-of-conformity.asp>.

Dealer Name: _____

Dealer Phone: _____

Notes:

800-578-DOGS (USA)
(865) 777-5404 (International)
400-1207
©2010 Radio Systems® Corporation
All rights reserved.

Protected by Patents:
U.S.: #5,425,330, #5,435,271, #5,476,729, #7,046,152,
#7,068,174, #7,117,822, #5,161,485
Canada: #2169261
U.K.: #0714235, #0720780
Ireland: #0714235, #0720780,
France: #0720780, #0714235
Germany: #0714235, #0720780